

Silownik kompaktowy DM 063 X 025 M

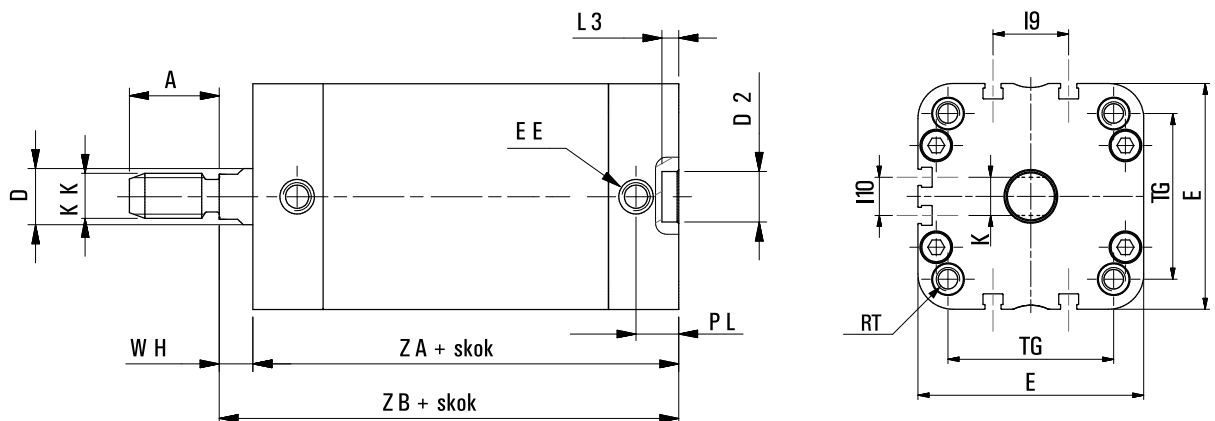

| | |
|------------------------|--------------------------|
| SKU | C-D-063-0025M |
| Producent | Pneumatig |
| srednica tłoka [mm] | 63 |
| skok silownika [mm] | 25 |
| przylacze | G 1/8? |
| działanie | dwustronne |
| zakres cisnienia [bar] | 1 - 10 |
| zakres temperatur [C] | 0 - 80 |
| korpus | aluminium anodowane |
| pokrywy | odlew aluminium |
| tłoczek | stal nierdzewna AISI 303 |
| uszczelnienia | poliuretan + NBR |
| amortyzacja | mechaniczna |



| Ø | A | ØD | ØD2 | RT | E | EE | I9 | I10 | K | KK | L3 | PL | TG | WH | ZA | ZB |
|------|----|----|-----|-----|-------|------|------|-----|----|--------------|----|------|------|----|----|----|
| Ø63 | 22 | 16 | 12 | M8 | 77 | G1/8 | 25,8 | 13 | 13 | M12 x1,25 | 4 | 7,5 | 56,5 | 8 | 49 | 57 |
| Ø80 | 28 | 20 | 12 | M10 | 95,5 | G1/8 | 30 | 18 | 17 | M16 x1,5 | 4 | 8 | 72 | 9 | 54 | 63 |
| Ø100 | 28 | 25 | 12 | M10 | 113,5 | G1/8 | 50 | 35 | 22 | M16 x1,5 | 4 | 10,5 | 89 | 10 | 67 | 77 |