

Silownik kompaktowy DM 040 X 040 M

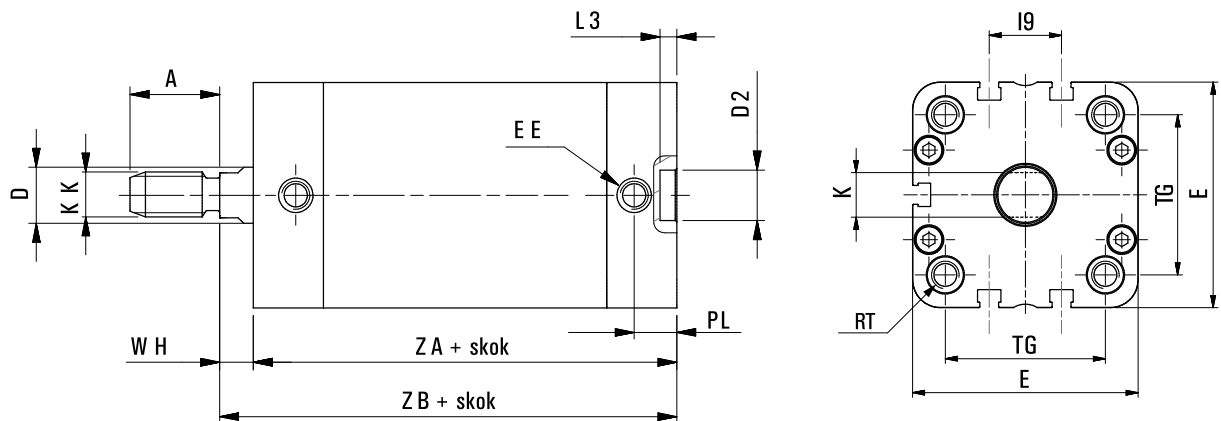

| | |
|------------------------|--------------------------|
| SKU | C-D-040-0040M |
| Producent | Pneumatig |
| srednica tłoka [mm] | 40 |
| skok silownika [mm] | 40 |
| przylacze | G 1/8? |
| działanie | dwustronne |
| zakres cisnienia [bar] | 1 - 10 |
| zakres temperatur [C] | 0 - 80 |
| korpus | aluminium anodyzowane |
| pokrywy | odlew aluminium |
| tłoczyisko | stal nierdzewna AISI 303 |
| uszczelnienia | poliuretan + NBR |
| amortyzacja | mechaniczna |



| Ø | A | ØD | ØD2 | RT | E | EE | I9 | K | KK | L3 | PL | TG | WH | ZA | ZB |
|-----|----|----|-----|----|------|------|------|----|--------------|----|----|------|----|----|----|
| Ø40 | 19 | 12 | 9 | M6 | 54,5 | G1/8 | 12,8 | 10 | M10 x1,25 | 3 | 8 | 38 | 7 | 45 | 52 |
| Ø50 | 22 | 16 | 12 | M8 | 65,5 | G1/8 | 21 | 13 | M12 x1,25 | 4 | 8 | 46,5 | 8 | 45 | 53 |